

CERTIFIED LAND CORNER RECORDATION

LOCATION

$\frac{1}{4}$
S.16 S.15
T.18N., R.63W.
6th P.M.

DESCRIPTION OF CORNER EVIDENCE FOUND, AND ORIGINAL RECORD (If known)

Found 4" x 10" x 14" sandstone, badly weathered, no marks visible.
Fence corner accepted as evidence of corner location.
G.L.O. record - Sandstone, 16 x 14 x 4. Contract survey by Charles A. Caton in 1873.

DESCRIPTION OF MONUMENT AND ACCESSORIES ESTABLISHED TO PERPETUATE THE ORIGINAL LOCATION OF THIS CORNER:

At the corner: Set a $\frac{1}{2}$ " dia. x 30" long iron pipe with brass cap.
Accessories: Left stone as memorial.

**SKETCH, WITH COURSE AND DISTANCE TO ADJACENT CORNER IF DETERMINED IN THIS SURVEY.
(May Sketch or Paste Reproduction on Reverse Side.)**

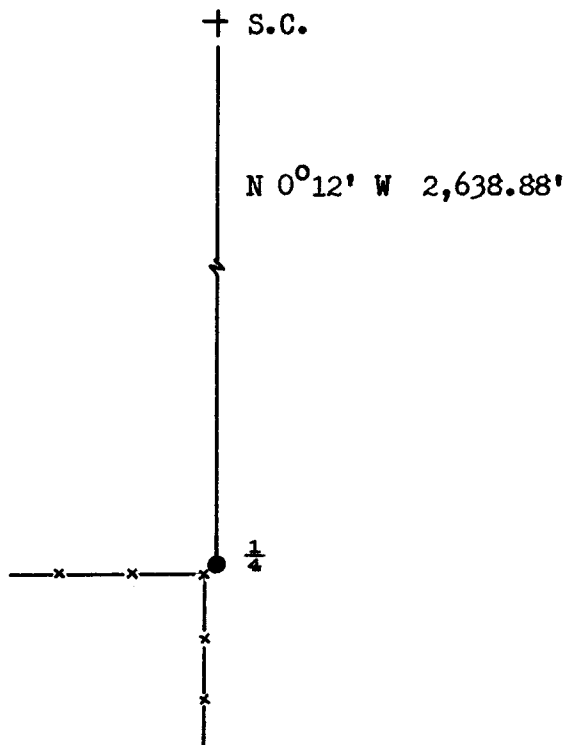

Basis of Bearing - By solar observation.



Not to Scale

Brass cap set .6" above ground.

Brass cap stamped:

T.18N. R.63W.

$\frac{1}{4}$

S.16 S.15

LS 519 1972

I, R.L. Hudson certify that I have carefully performed ~~or reviewed~~ the work done on the diagrammed corner as reported on this recordation form and approve the same.

R.L. Hudson
Signature of Surveyor

Wyoming L.S. No. 519
Registration No.

STATE OF WYOMING,
Office of Clerk and Recorder,
County of Laramie

This "corner record" was filed for record on the 30th day of October, 1972, was noted on the cross-index plat and is assigned page No. 18-63, in book No. ONE

John B. Hillman
County Official

Cross Index No. _____	T. _____	R. _____	Mer. _____
_____	T. _____	R. _____	Mer. _____
_____	T. _____	R. _____	Mer. _____
_____	T. _____	R. _____	Mer. _____
_____	T. _____	R. _____	Mer. _____
_____	T. _____	R. _____	Mer. _____
_____	T. _____	R. _____	Mer. _____

The State of Wyoming }
County of Laramie } SS

This instrument was filed for record
at 2:01 o'clock P. M. on the
30th day of October
A. D. 19 22 and duly recorded in
Book on page

John B. Williams

County Clerk & Ex-Officio Register of Deeds
By _____ Deputy